

# Installation Guide

## FIREFLYSpan

### Verticle Substrates

#### Step 1 | Product Selection

FIREFLYSpan is available in three different sizes -

- FIREFLYSpan 50, from 25 mm up to 50 mm wide joints
- FIREFLYSpan 75, from 35 mm up to 75 mm wide joints
- FIREFLYSpan 100, from 51 mm up to 100 mm wide joints

Measure the joint width and depth to determine which size FIREFLYSpan is appropriate for the application.

Also, consult the relevant report to ensure the correct product selection, correctly identify the application and to ensure that the substrate meets the minimum thickness required.



## Step 2 | Substrate Preparation

1. Ensure that the substrates are prepared accordingly, before proceeding with the FIREFLYSpan installation.

Some substrates require lining of the gap edges -

- Fire rated plasterboard walls - to be lined on both sides with 2 x 13 mm fire rated plasterboard
- Timber walls - to be lined on both sides with 1 x 16 mm fire rated plasterboard.

2. Ensure the gap surfaces are clean of debris.

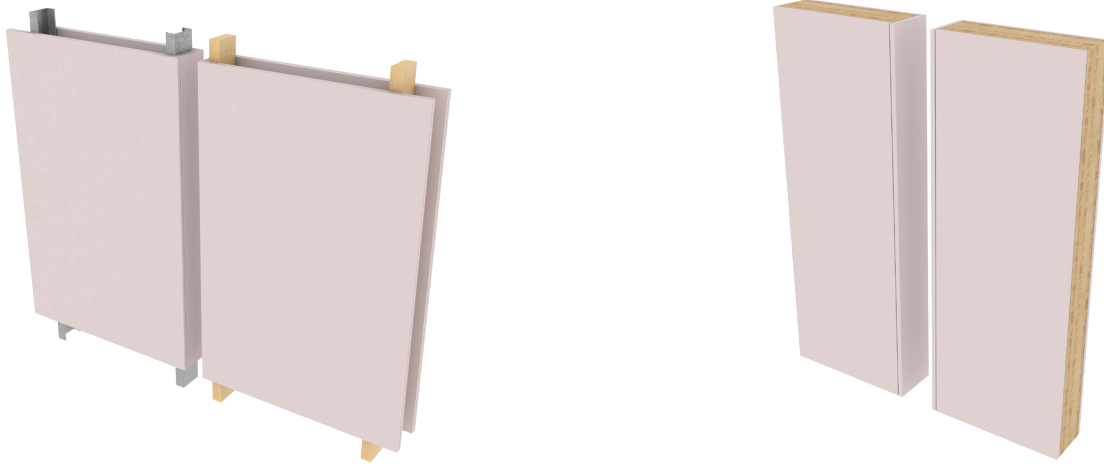

## Step 3 | Installation

For FIREFLYSpan 50, 75 and 100

1. Friction fit the 1 m length of FIREFLYSpan into the gap.
2. Butt up the next length and continue to fill the gap.
3. Where a full length of FIREFLYSpan is too long to fit in the gap (eg. fitting the last piece that closes the gap), it can be cut to size to suit the gap's remaining length, ensuring that the FIREFLYSpan is friction fit. Cutting the FIREFLYSpan can be easily done with the use of knife, a box-cutter, or similar.

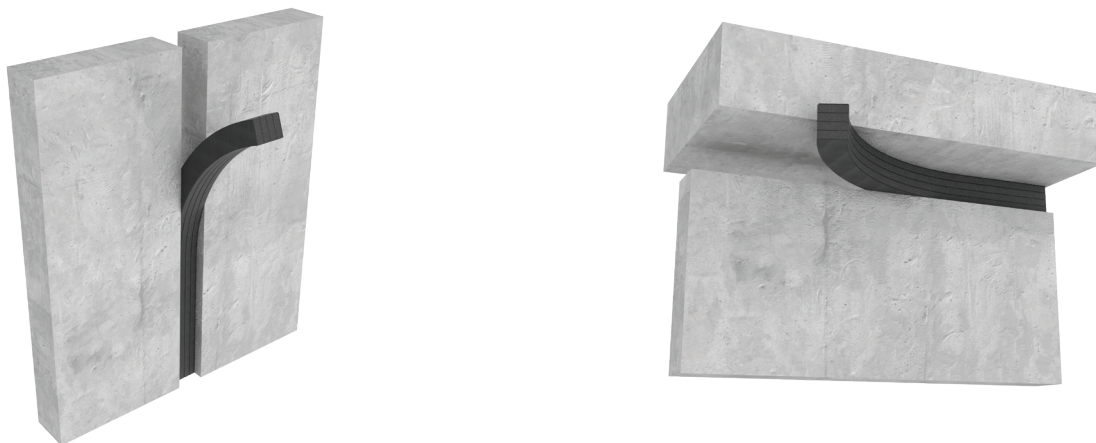

### Note:

1. Off-cut pieces of FIREFLYSpan can be used together with full length pieces, minimising waste.
2. FIREFLYMastic or FIREFLYMasticBG can be used to assist with the installation, by applying it to the edges of the gap and/or the FIREFLYSpan sides that touch the substrate, minimising friction between the FIREFLYSpan and the substrate, and enhancing the smoke seal capability of the solution. The use of these products is purely optional.

# Horizontal Substrates

## Step 1 | Product Selection

FIREFLYSpan is available in three different sizes -

- FIREFLYSpan 50, from 25 mm up to 50 mm wide joints
- FIREFLYSpan 75, from 35 mm up to 75 mm wide joints
- FIREFLYSpan 100, from 51 mm up to 100 mm wide joints

Measure the joint width and depth to determine which size span is appropriate for the application.

Also, consult the relevant report to ensure the correct product selection, correctly identify the application and to ensure that the substrate meets the minimum thickness required.

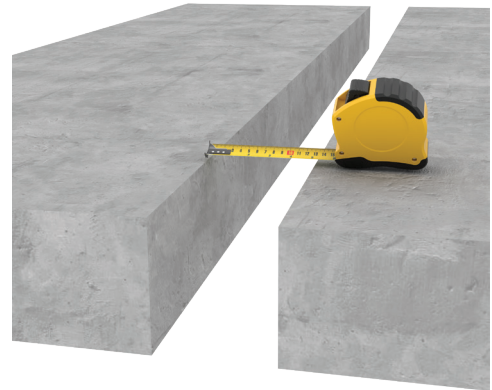

## Step 2 | Installation

Prior to proceeding with the installation, ensure the gap surfaces are clean of debris.

**For FIREFLYSpan 50, 75 and 100**

1. Friction fit the 1 m length of FIREFLYSpan into the gap.
2. Butt up the next length and continue to fill the gap.
3. Where a full length of FIREFLYSpan is too long to fit in the gap (eg. fitting the last piece that closes the gap), it can be cut to size to suit the gap's remaining length, ensuring that the FIREFLYSpan is friction fit. Cutting the FIREFLYSpan can be easily done with the use of knife, a box-cutter, or similar.

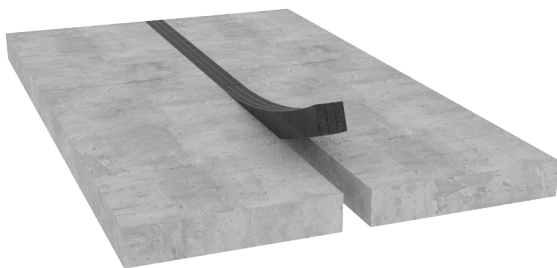

### Note:

1. Off-cut pieces of FIREFLYSpan can be used together with full length pieces, minimising waste.
2. FIREFLYMastic or FIREFLYMasticBG can be used to assist with the installation, by applying it to the edges of the gap and/or the FIREFLYSpan sides that touch the substrate, minimising friction between the FIREFLYSpan and the substrate, and enhancing the smoke seal capability of the solution. The use of these products is purely optional.